

Central Brass

C O M P A N Y

Brecksville, Ohio 44141

Phone: (216) 883-0220 Fax: (440) 526-5745

www.CentralBrass.com

**MODEL NO. 80084-GSAELS
BAR/LAUNDRY FAUCET**

The 4-inch center topmounted bar/laundry faucet has a cast brass body that is copper, nickel and chrome plated. The compression stems are all brass with a double O-Ring seal and rubber seat washer. The 4-inch wrist blade handles are brass with a color coded hot (red) and cold (blue) index. The swivel gooseneck spout is brass with a chrome plated finish and is fitted with a water saving aerator that limits the flow rate. The O-Rings and seals are rubber.

Flow Rate: 2.0 GPM @ 60 psi

ADA Compliant and Meets ASME A112.18.1M

Certified by IAPMO R&T to NSF/ANSI 61



Installation Drawing

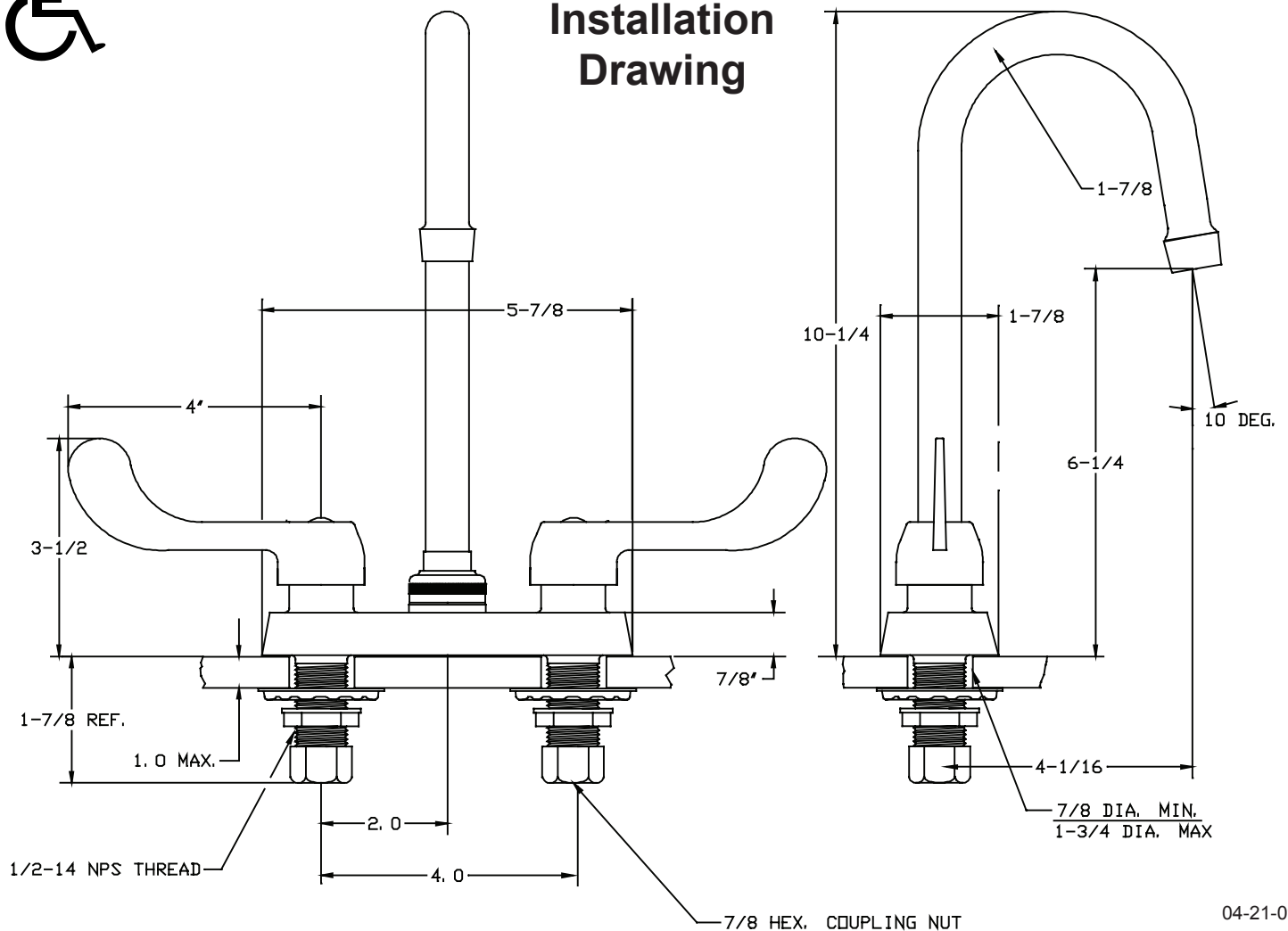

Central Brass

COMPANY

Brecksville, Ohio 44141

Phone: (216) 883-0220 Fax: (440) 526-5745

www.CentralBrass.com

**MODEL NO. 80084-GSAELS
BAR/LAUNDRY FAUCET**

Parts Breakdown

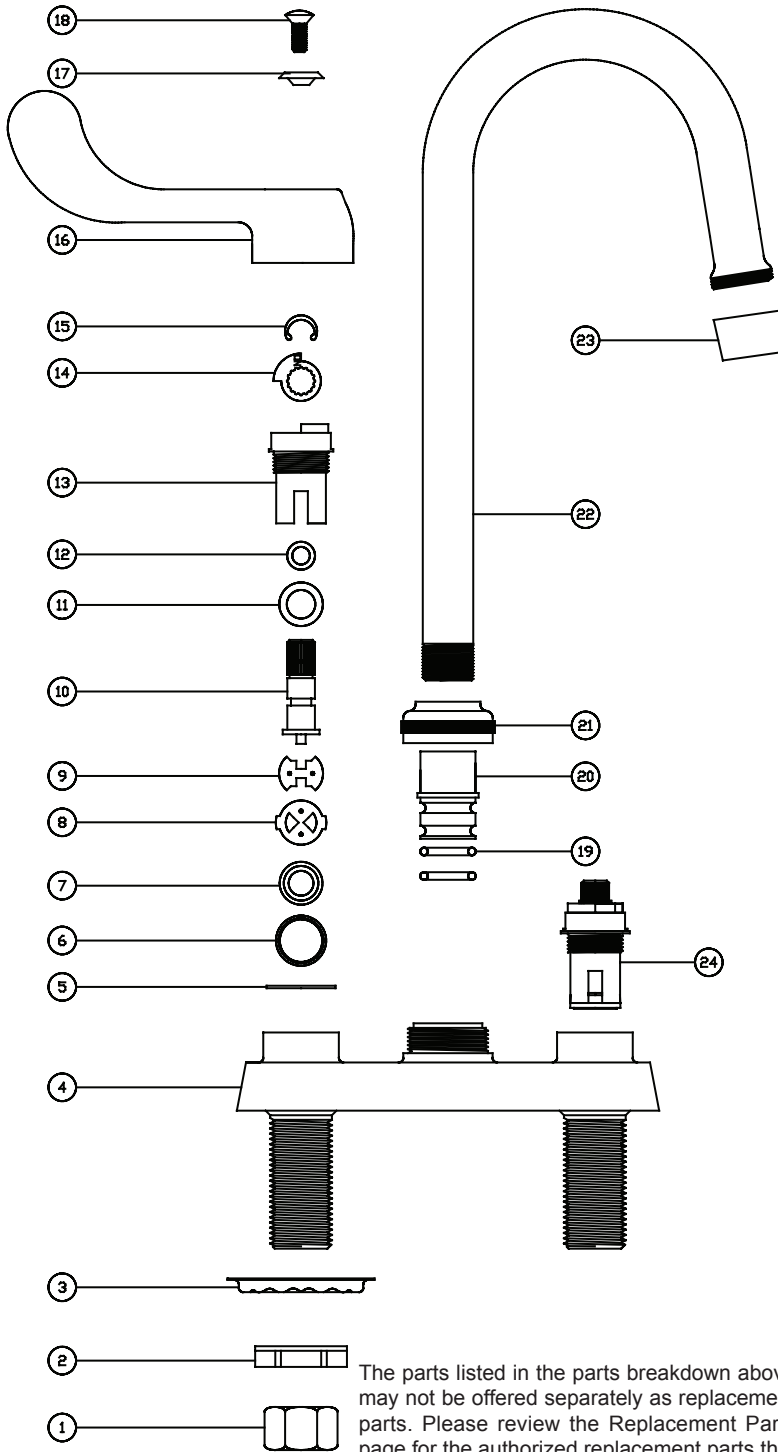

| # | Part # | Description |
|----|--------------|----------------------------|
| 1 | 4015-BAR | Brass Coupling Nut |
| 2 | 7133-AL | Zinc Dichromate Locknut |
| 3 | 54 | Steel Crowfoot Washer |
| 4 | 2103-B | Brass Faucet Body |
| 5 | 1028-Y | Nylon Gasket |
| 6 | 184-A | Celcon Retainer |
| 7 | 183-A | Rubber Seal |
| 8 | 182 | Ceramic Disc - Lower |
| 9 | 181 | Ceramic Disc - Upper |
| 10 | 352-S | Brass Stem |
| 11 | 180 | Celcon Washer |
| 12 | 1038-E14 | Rubber O-Ring |
| 13 | 352-B | Brass Bonnet |
| 14 | 352-SS | Brass Stop |
| 15 | 352-CR | Brass C-Ring |
| 16 | 4147-02 | Brass Handle |
| 17 | 107-FB | Color Coded Index - Blue |
| 17 | 107-FR | Color Coded Index -Red |
| 18 | PF-107-FNP | Brass Screw |
| 19 | 1038-KN | Rubber O-Ring |
| 20 | PF-741-DOA | Brass Adapter |
| 21 | PF-782-DES | Brass Spout Nut |
| 22 | PF-157-GA-02 | Brass Spout |
| 23 | 30-M | Female Aerator |
| 24 | SU-352-L | Left Thread Stem Assembly |
| 24 | SU-352-R | Right Thread Stem Assembly |

The parts listed in the parts breakdown above may not be offered separately as replacement parts. Please review the Replacement Parts page for the authorized replacement parts that are available for this item.