

PUSHLOCK™

PUSH-FIT TECHNOLOGY

PUSH-FIT
CONNECTION SYSTEM
FITTINGS & VALVES
PEX, CPVC or Copper

 **LEAD
FREE**



PUSHLOCK

PUSH-FIT TECHNOLOGY

THE SMART PLUMBING SOLUTION
QUICK & EASY CONNECTION

VALVES & FITTINGS

FEATURES & BENEFITS

- Shortens repair time on jobs.
- Lead Free removable brass fittings in sizes 1/2" to 1".
- Certified for potable water and hydronic applications.
- No Tools, No Heat, No Glue, No Flux and No Solder required.
- Connects PEX, CPVC, or COPPER pipe in any combination.
- Quick and easy, removable and reusable installation.
- Made with Lead Free DZR Forged Brass.
- Ideal for service and repair - even on wet lines.
- Pre-lubricated for quick installation.
- EPDM O-Ring for leak free seals.

SPECIFICATIONS & APPROVALS

- Certified to 200 PSI and 200°F
- Certified by UPC / IAPMO, to meet Lead-Free Potable Water Laws.
- ANSI/NSF-14/G Compliant
- AWWA C800 Compliant
- Meets ASME B1.20.1, ASSE 1061
- Manufactured in an ISO Accredited Facility.



PUSH-FIT VALVES

IMAGE	ITEM #	SIZE	INNER	MASTER
-------	--------	------	-------	--------

PUSH x PUSH BALL VALVE



UPBV12	1/2"	5	50
UPBV34	3/4"	5	50
UPBV1	1"	3	30

- Lead Free
- 1/4 Turn On/Off
- 200PSI WOG
- Full port ball valve design
- Forged brass construction
- Single lever heavy duty rust resistant handle with vinyl grip

IMAGE	ITEM #	SIZE	INNER	MASTER
-------	--------	------	-------	--------

PUSH x FEMALE BALL VALVE



UPBVF12	1/2"	5	50
UPBVF34	3/4"	5	50
UPBVF1	1"	3	30

- Lead Free
- 1/4 Turn On/Off
- 200PSI WOG
- Full port ball valve design
- Forged brass construction
- Single lever heavy duty rust resistant handle with vinyl grip

IMAGE	ITEM #	SIZE	INNER	MASTER
-------	--------	------	-------	--------

PUSH-FIT 1/4 TURN ANGLE STOP



UPASC1214	1/2" x 1/4"C	5	30
UPASC1238	1/2" x 3/8"C	5	30
UPASP1212	1/2" x 1/2"	5	30

- Lead Free
- 1/4 Turn On/Off
- 200PSI WOG
- Chrome finish
- Metal handle
- Slim fitting design

IMAGE	ITEM #	SIZE	INNER	MASTER
-------	--------	------	-------	--------

PUSH-FIT 1/4 TURN STRAIGHT STOP



UPSSC1214	1/2" x 1/4"C	5	30
UPSSC1238	1/2" x 3/8"C	5	30
UPSSP1212	1/2" x 1/2"	5	30

- Lead Free
- 1/4 Turn On/Off
- 200PSI WOG
- Chrome finish
- Metal handle
- Slim fitting design

PUSH-FIT FITTINGS

IMAGE	ITEM #	SIZE	INNER	MASTER
-------	--------	------	-------	--------

COUPLINGS



PUSH x PUSH

UPSC12	1/2"	25	250
UPSC34	3/4"	15	150
UPSC1	1"	5	50

REDUCING

UPSC3412	3/4" x 1/2"	15	150
UPSC134	1" x 3/4"	5	50

ADAPTERS



PUSH x FEMALE

UPFC12	1/2"	30	300
UPFC34	3/4"	15	150
UPFC1	1"	5	50

REDUCING

UPFC1234	1/2" x 3/4"	15	150
UPFC134	1" x 3/4"	5	50



PUSH x MALE

UPMC12	1/2"	25	250
UPMC34	3/4"	15	150
UPMC1	1"	5	50

REDUCING

UPMC1234	1/2" x 3/4"	15	150
UPMC134	1" x 3/4"	5	50

TEES



PUSH x PUSH x PUSH

UPET12	1/2"	10	100
UPET34	3/4"	5	50
UPET1	1"	3	30

REDUCING

UPET121234	1/2" x 1/2" x 3/4"	10	100
UPET12121	1/2" x 1/2" x 1"	5	50
UPET341212	3/4 x 1/2 x 1/2	3	30
UPET341234	3/4" x 1/2" x 3/4"	10	100
UPET343412	3/4" x 3/4" x 1/2"	5	50
UPET1134	1" x 1" x 3/4"	3	30

FEMALE CENTER TEES



PUSH x PUSH x FEMALE

UPCTF12	1/2"	10	100
UPCTF34	3/4"	5	50

IMAGE	ITEM #	SIZE	INNER	MASTER
-------	--------	------	-------	--------

ELBOWS



PUSH x PUSH

UPE9012	1/2"	30	300
UPE9034	3/4"	15	150
UPE901	1"	5	50

REDUCING

UPE903412	3/4" x 1/2"	10	100
-----------	-------------	----	-----



PUSH x FEMALE

UPFE12	1/2"	15	150
UPFE34	3/4"	10	100
UPFE1	1"	5	50



PUSH x MALE

UPME12	1/2"	20	200
UPME34	3/4"	10	100
UPME1	1"	5	50

DROP EAR ELBOW



PUSH x FEMALE

UPDEF1212	1/2"	20	200
-----------	------	----	-----

SLIP FITTINGS



SLIP COUPLING PUSH x PUSH

UPRC1212	1/2"	10	100
UPRC3434	3/4"	5	50



SLIP TEE PUSH x PUSH x PUSH

UPRT1212	1/2"	5	50
UPRT3434	3/4"	5	50



PUSH-FIT STOP END

UPSE12	1/2"	30	300
UPSE34	3/4"	20	200
UPSE1	1"	15	150



REMOVAL TOOL

UPTR012	1/2"	25	250
UPTR034	3/4"	25	250
UPTR001	1"	25	250

PUSH-FIT STAINLESS STEEL WATER HEATER CONNECTORS



ITEM #	SIZE	INNER	MASTER
--------	------	-------	--------

STAINLESS STEEL BRAIDED WATER HEATER CONNECTOR

FTWC-B34-15C	3/4" FIP X 3/4" PUSH	1	25
FTWC-B34-18C	3/4" FIP X 3/4" PUSH	1	25

ITEM #	SIZE	INNER	MASTER
--------	------	-------	--------

STAINLESS STEEL CORRUGATED WATER HEATER CONNECTOR

FTWC-S34-18C	3/4" FIP X 3/4" PUSH	1	25
FTWC-S34-24C	3/4" FIP X 3/4" PUSH	1	25

PUSH X STREET ADAPTER W/ 5" EXTENSION

IMAGE	ITEM #	SIZE	INNER	MASTER
-------	--------	------	-------	--------

NEW
INNOVATIVE
SOLUTION



PUSH x STREET REPAIR EXTENSION

UPCS1212	1/2" Push x 1/2" Street	5	50
----------	-------------------------	---	----

- Lead Free
- Forged brass and copper construction
- UPC Certified
- Compatible with Copper, CPVC, PEX, & PE-RT
- NSF 61/372/14
- ASSE 1061

When water line connection from wall is too short, simply attach the Push x Street Repair Extension.

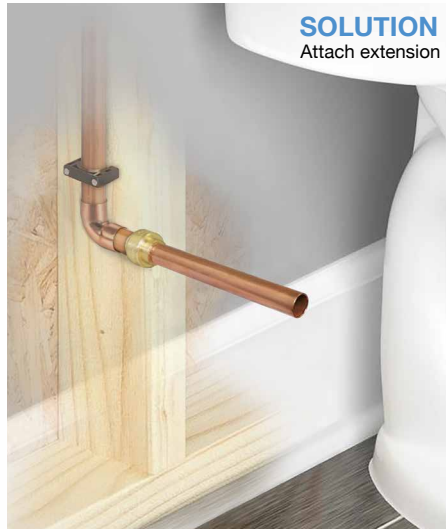

The Push x Street Repair Extension can also be used with a coupling to replace and repair larger areas of pipe.



UNIBOX



Includes: 2 boxes, 2 valves & nuts, faceplates, mounting brackets and interlocking center clip

SINGLE PART#	DOUBLE PART #	DESCRIPTION	CASE	PALLET
Push-Fit Unibox Double Interlocking Box				
SB110-U	SB120-U	Double Interlocking Box	10	440
SB110-UH	SB120-UH	Double Interlocking Box w/ Hammer Arrestor	10	440

CENTER BOX



Includes: 2 valves & nuts, faceplate and 2 mounting brackets

ITEM #	DESCRIPTION	CASE	PALLET
Push-Fit Center Outlet Washing Machine Box			
SB300-U	Center Outlet Box - Valves Installed	10	440
SB300-UH	Center Outlet Box w/ Hammer Arrestor	10	440

FLEX BOX

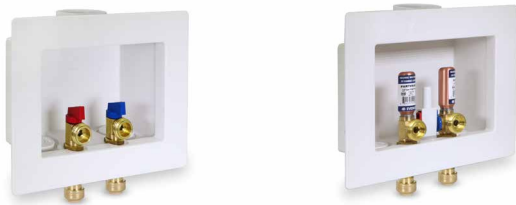

Includes: 2 valves & nuts, faceplate and 2 mounting brackets

ASSEMBLED#	UNASSEMBLED#	DESCRIPTION	CASE	PALLET
Push-Fit Flexbox Dual Outlet Box				
SB200-U	SB201-U	Dual Outlet Box	12	480
SB200-UH	SB201-UH	Dual Outlet Box w/ Hammer Arrestor	12	480

UniBox Icemaker



Includes: Valve & nut, faceplate, mounting brackets and interlocking center clip

PART#	DESCRIPTION	CASE	PALLET
Push-Fit Unibox Icemaker Outlet Box			
SB100-U	Icemaker Outlet Box	20	880
SB100-UH	Icemaker Outlet Box w/ Hammer	20	880

Washing Machine Valve



RED PART#	BLUE PART#	DESCRIPTION	CASE	PALLET
Washing Machine Valves				
540U	541U	1/4 Turn Valve Top Handle	10	100
540UH	541UH	1/4 Turn Valve w/ Hammer	5	50



Ice Maker Valve



PART#	DESCRIPTION	INNER	MASTER
Ice Maker Valve			
545U	White 1/4 Turn Icemaker Valve	10	100
545UH	White 1/4 Turn Icemaker Valve With Hammer	5	50



PUSHLOCK

PUSH-FIT TECHNOLOGY

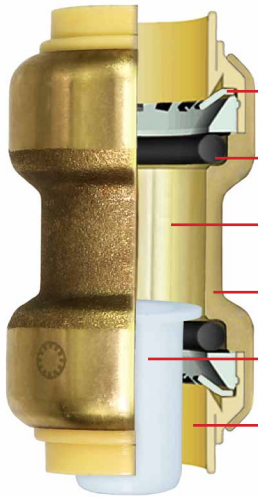

- Stainless Steel Gripper Provides Secure Connection
- EPDM Rubber O-Ring Prevents Water Leakage
- Lead Free Compliant for Safe Drinking Water
- DZR Forged Brass Material Prevents Corrosion
- Pipe Stiffener Included for Secure PEX Connection
- Plastic Release Collar Enables Quick Removal and Reuse



- CONNECTS TO
- PEX
 - CPVC
 - COPPER

INSTALLATION

CONNECTING A JOINT

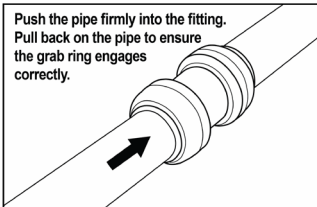
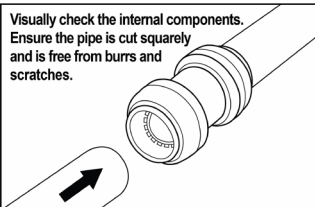

Select the correct size fitting and pipe for the job. Check that fittings and pipe are clean, in good condition and are free from damage and foreign objects. Cut the pipe so that the ends are square. Ensure that there are no burrs or damage to the cut end. Once the pipe end is cut square and clean, use a permanent marker to mark the insert depth on the outside of the pipe. This mark is used to ensure that the joint is assembled correctly. To assemble correctly, the pipe needs to be pushed into the fitting until it meets the tube stop. Follow these three steps to insert the pipe into the fitting.

1. Insert the pipe through the release collar against the grab ring.
2. Push the pipe firmly with a slight twisting action until it reaches the tube stop.
3. To ensure that the pipe is correctly inserted, check that the depth mark is within 0.005 in (0.13 mm) of the end of the release collar.

DISCONNECTING A JOINT

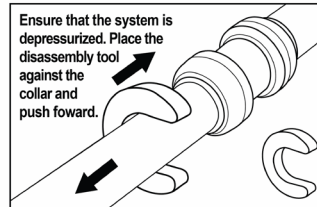

Disconnection of the joint can only occur by using the PUSHLOCK removal tool. By applying pressure to the release collar with the removal tool, the grab ring teeth are splayed. This action releases the pipe, allowing it to be removed from the fitting.

1. Place the PUSHLOCK removal tool around the pipe with the non-branded face against the release collar. The end with the size displayed on the removal tool should be positioned around the pipe and the other end around the neck of the fitting.
2. Push the removal tool against the release collar and pull the pipe with a twisting action to release the pipe.
3. Check the fitting and pipe end for damage. The fitting and pipe should be free of damage, foreign objects and marks on the outside diameter. If the pipe is damaged or marked, then cut and use a new section of pipe.

WARRANTY

All products must be installed in accordance with all the applicable codes, good plumbing practice, in accordance with any local, state, provincial or federal requirements, and installed in a potable water or radiant heating application unless a non-potable water service is specifically allowed for in the pertinent product literature. The installer must use construction techniques compliant with then applicable codes to install the product and use the product within the design parameters specified in any installation guidelines and technical notes for the applicable system. This shall include field pressure testing prior to concealing with concrete or by other means and wrapping any brass fitting when buried. Failure to install PUSHLOCK products according to manufacturer's installation instruction will void all applicable warranties and may result in severe water damage. Products must at all times be used in a manner consistent with their intended use and be used in installations and environments acceptable to their material and design specifications, including not being installed in a system that may operate at temperatures or at pressures that exceed the approved ratings which can be found on the product documentation or installation instructions. Without limiting the foregoing, this Limited Warranty does not apply and you do not have a right of reimbursement if the product failure or resulting damage is caused by: (a) evidence of tampering, mishandling, neglect, abuse, accidental damage, freeze damage (it is expressly understood that failure as a result of any freezing fluids within the pipes does not constitute a defect in material or workmanship and shall not be covered by this warranty) or unauthorized modifications or repairs that cause damage to warranted products; (b) exposure to harmful, unauthorized, or unanticipated chemicals or substances or corrosive water conditions; (c) exposure to ultraviolet light; (d) faulty installation including failure to follow proper burial instructions; (e) damage from abnormal operating conditions including exposure pressures and temperatures beyond the specified operating range; (f) failure to properly test and pass common testing methods (including pressure testing) after the installation and before the product or system is put in service; (g) components not manufactured or sold by PUSHLOCK; or (h) acts of nature such as earthquakes, fire, flood or lightning. Although PUSHLOCK provides a plumbing system to facilitate a complete installation, other manufacturers pipe and/or fittings may be installed in any given installation provided manufacturing of the pipe and/or fittings demonstrates compliance with the applicable ASTM/CSA standards, and the product has been certified by a recognized third-party testing agency. The PUSHLOCK product in the given installation will continue to be covered under this Limited Warranty although limits on Warranty Period may apply. PUSHLOCK will be responsible only for proven defects in material or workmanship in PUSHLOCK products. Problems in products manufactured by another company should be reported to that manufacturer.