



DUCTILE / CAST IRON
**FLANGED
FITTINGS**





DUCTILE / CAST IRON FLANGED FITTINGS SPECIFICATION SHEET

FLANGED FITTINGS DUCTILE / CAST IRON CLASS 125

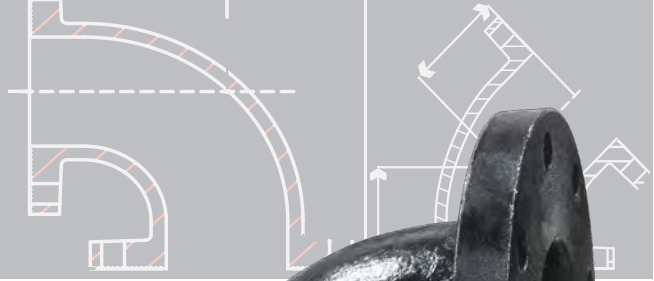

- Cement lined flanged fittings UL listed through 12"
- Iron castings conform to ASTM A126 and ASTM A48
- Flanged fitting dimensions conform to ASME B16.1 and ANSI/AWWA C110/A21.10
- Flanged fittings 6" and smaller are made from ductile iron and meet ASME B16.42 Class 125
- Manufacturing facility is ISO 9001:2008



CAST IRON FLANGES COMPANION & BLIND CLASS 150

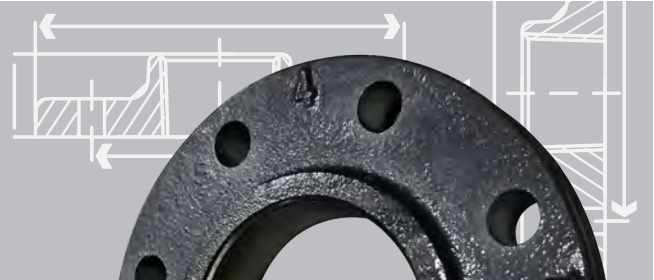

- Iron castings conform to ASTM A536
- Flange dimensions, drilling and materials in accordance with AWWA C110/ASME B16.42
- Hot-dipped galvanized flanges conform to ASTM A153
- Companion flange threads conform to ASME B1.20.1
- Manufacturing facility is ISO 9001:2008



DUCTILE / CAST IRON FLANGED FITTINGS

Class 125 Cement lined black flanged fittings · Class 150 Flanges available in Black and Galvanized · Flanged fittings UL Listed through 12" Castings conform to ASTM A126, ASTM A48 and ASTM A536 Fittings conform to ASME B16.1 and ANSI/AWWA C110/A21.10 Flanges conform to AWWA C110 / ASME B16.42 / ASME B1.20.1 · Flanged fittings 6" and smaller are made from ductile iron and meet ASME B16.42 Class 150 Manufacturing facility is ISO 9001:2008



FLANGED 90° ELBOW

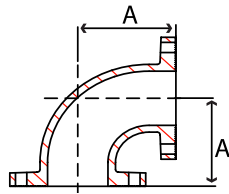

PART #	SIZE	DESCRIPTION	A	WEIGHT	QTY
FGEL03B	3"	150 Ductile Iron	5.5	25	100
FGEL04B	4"	150 Ductile Iron	6.5	45	60
FGEL05B	5"	150 Ductile Iron	7.5	52	45
FGEL06B	6"	150 Ductile Iron	8.0	65	37
FGEL08B	8"	125 Cast Iron	9.0	105	22
FGEL10B	10"	125 Cast Iron	11.0	165	15
FGEL12B	12"	125 Cast Iron	12.0	255	9

FLANGED REDUCING 90°

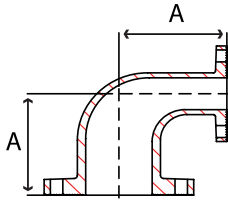

PART #	SIZE	DESCRIPTION	A	WEIGHT	QTY
FGEL0302B	3" x 2"	150 Ductile Iron	5.5	22	110
FGEL0403B	4" x 3"	150 Ductile Iron	6.5	29	68
FGEL0604B	6" x 4"	150 Ductile Iron	8.0	55	40
FGEL0806B	8" x 6"	150 Ductile Iron*	9.0	85	25
FGEL1008B	10" x 8"	125 Cast Iron	11.0	150	16

FLANGED 45° ELBOW

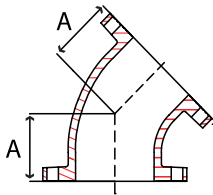

PART #	SIZE	DESCRIPTION	A	WEIGHT	QTY
FGFE04B	4"	150 Ductile Iron	4.0	40	70
FGFE06B	6"	150 Ductile Iron	5.0	55	45

FLANGED TEE

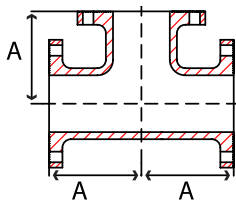

PART #	SIZE	DESCRIPTION	A	WEIGHT	QTY
FGTE02B	2"	150 Ductile Iron	4.5	20	120
FGTE0212B	2-1/2"	150 Ductile Iron	5.0	30	80
FGTE03B	3"	150 Ductile Iron	5.5	40	65
FGTE04B	4"	150 Ductile Iron	6.5	65	40
FGTE05B	5"	150 Ductile Iron	7.5	85	24
FGTE06B	6"	150 Ductile Iron	8.0	95	24
FGTE08B	8"	125 Cast Iron	9.0	155	15
FGTE10B	10"	125 Cast Iron	11.0	270	9
FGTE12B	12"	125 Cast Iron	12.0	385	6



DUCTILE / CAST IRON FLANGED FITTINGS

Class 125 Cement lined black flanged fittings • Class 150 Flanges available in Black and Galvanized • Flanged fittings UL Listed through 12" Castings conform to ASTM A126, ASTM A48 and ASTM A536 Fittings • conform to ASME B16.1 and ANSI/AWWA C110/A21.10 Flanges conform to AWWA C110 / ASME B16.42 / ASME B1.20.1 • Flanged fittings 6" and smaller are made from ductile iron and meet ASME B16.42 Class 150 Manufacturing facility is ISO 9001:2008

FLANGED REDUCING TEE

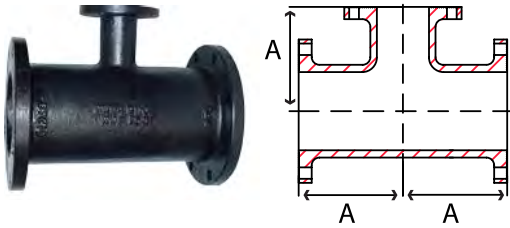

PART #	SIZE	DESCRIPTION	A	WEIGHT	QTY
FGRT0302B	3" x 2"	150 Ductile Iron	-	-	67
FGRT0402B	4" x 2"	150 Ductile Iron	-	-	44
FGRT0403B	4" x 3"	150 Ductile Iron	-	-	36
FGRT0602B	6" x 2"	150 Ductile Iron	-	-	25
FGRT0603B	6" x 3"	150 Ductile Iron	8.0	85	24
FGRT0604B	6" x 4"	150 Ductile Iron	8.0	90	24
FGRT0806B	8" x 6"	150 Ductile Iron	9.0	145	16
FGRT1008B	10" x 8"	125 Cast Iron	11.0	225	10

CONCENTRIC REDUCER

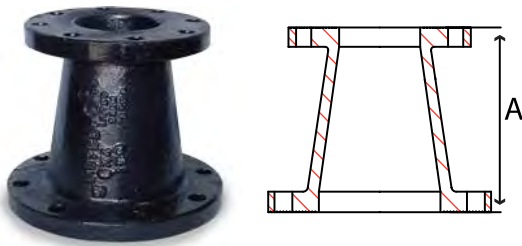

PART #	SIZE	DESCRIPTION	A	WEIGHT	QTY
FGCR0302B	3" x 2"	150 Ductile Iron	6.0	16	140
FGCR0403B	4" x 3"	150 Ductile Iron	7.0	30	80
FGCR0603B	6" x 3"	150 Ductile Iron	9.0	40	60
FGCR0604B	6" x 4"	150 Ductile Iron	9.0	45	55
FGCR0605B	6" x 5"	150 Ductile Iron	9.0	50	50
FGCR0806B	8" x 6"	150 Ductile Iron	11.0	75	33
FGCR106B	10" x 6"	150 Ductile Iron	12.0	93	24
FGCR1008B	10" x 8"	125 Cast Iron	12.0	109	22

ECCENTRIC REDUCER



PART #	SIZE	DESCRIPTION	A	WEIGHT	QTY
FGER0403B	4" x 3"	150 Ductile Iron	7.0	30	80
FGER0604B	6" x 4"	150 Ductile Iron	9.0	45	55
FGER0806B	8" x 6"	150 Ductile Iron	11.0	75	33
FGER1008B	10" x 8"	125 Cast Iron	12.0	110	22

DUCTILE / CAST IRON FLANGED FITTINGS

Class 125 Cement lined black flanged fittings · Class 150 Flanges available in Black and Galvanized · Flanged fittings UL Listed through 12" Castings conform to ASTM A126, ASTM A48 and ASTM A536 Fittings · conform to ASME B16.1 and ANSI/AWWA C110/A21.10 Flanges conform to AWWA C110 / ASME B16.42 /ASME B1.20.1 · Flanged fittings 6" and smaller are made from ductile iron and meet ASME B16.42 Class 150 Manufacturing facility is ISO 9001:2008



THREADED COMPANION FLANGE

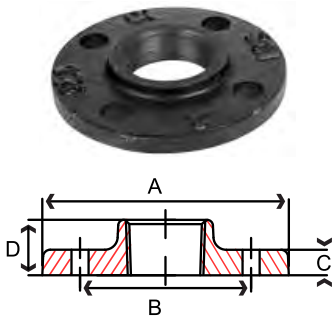

PART #	SIZE	DESCRIPTION	A	B	C	D	WEIGHT	QTY
FGCF0112B	1-1/2"	125 Cast Iron Black	5.00	3.88	0.56	0.88	3	900
FGCF02B	2"	125 Cast Iron Black	6.00	4.75	0.62	1.00	4	560
FGCF0212B	2-1/2"	125 Cast Iron Black	7.00	5.50	0.69	1.12	6	360
FGCF03B	3"	125 Cast Iron Black	7.50	6.00	0.75	1.19	8	320
FGCF04B	4"	125 Cast Iron Black	9.00	7.50	0.94	1.31	12	200
FGCF05B	5"	125 Cast Iron Black	10.00	8.50	0.94	1.44	14	140
FGCF06B	6"	125 Cast Iron Black	11.00	9.50	1.00	1.56	16	110
FGCF08B	8"	125 Cast Iron Black	13.50	11.75	1.12	1.75	28	60
FGCF02G	2"	125 Cast Iron Galvanized	6.00	4.75	0.62	1.00	4	560
FGCF0212G	2-1/2"	125 Cast Iron Galvanized	7.00	5.50	0.69	1.12	6	360
FGCF03G	3"	125 Cast Iron Galvanized	7.50	6.00	0.75	1.19	8	300
FGCF04G	4"	125 Cast Iron Galvanized	9.00	7.50	0.94	1.31	12	200
FGCF06G	6"	125 Cast Iron Galvanized	11.00	9.50	1.00	1.56	16	110

REDUCING COMPANION FLANGE

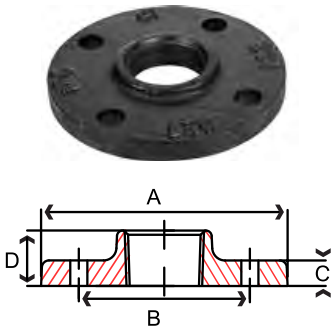

PART #	SIZE	DESCRIPTION	A	B	C	D	WEIGHT	QTY
FGRC020712B	2" x 7-1/2"	125 Cast Iron Black	7.50	6.00	0.75	1.19	8	300
FGRC0209B	2" x 9"	125 Cast Iron Black	9.00	7.50	0.94	1.31	16	170
FGRC0211B	2" x 11"	125 Cast Iron Black	11.00	9.50	1.00	1.56	23	107
FGRC02120712B	2-1/2" x 7-1/2"	125 Cast Iron Black	7.50	6.00	0.75	1.19	8	300
FGRC021209B	2-1/2" x 9"	125 Cast Iron Black	9.00	7.50	0.94	1.31	13	190
FGRC0309B	3" x 9"	125 Cast Iron Black	9.00	7.50	0.94	1.31	13	190
FGRC0311B	3" x 11"	125 Cast Iron Black	11.00	9.50	1.00	1.56	21	110
FGRC0411B	4" x 11"	125 Cast Iron Black	11.00	9.50	1.00	1.56	21	110
FGRC041312B	4" x 13-1/2"	125 Cast Iron Black	13.50	11.75	1.12	1.75	35	65
FGRC061312B	6" x 13-1/2"	125 Cast Iron Black	13.50	11.75	1.12	1.75	30	65
FGRC020712G	2" x 7-1/2"	125 Cast Iron Galvanized	7.50	6.00	0.75	1.19	8	300
FGRC0209G	2" x 9"	125 Cast Iron Galvanized	9.00	7.50	0.94	1.31	16	160
FGRC0309G	3" x 9"	125 Cast Iron Galvanized	9.00	7.50	0.94	1.31	13	180
FGRC0411G	4" x 11"	125 Cast Iron Galvanized	11.00	9.50	1.00	1.56	21	110

BLIND FLANGE

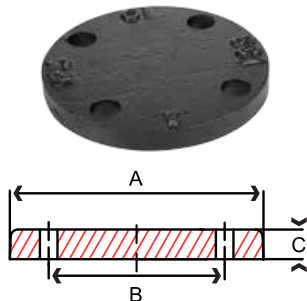

PART #	SIZE	DESCRIPTION	A	B	C	WEIGHT	QTY
FGBF02B	2"	125 Cast Iron	6.00	4.75	0.62	5	490
FGBF03B	3"	125 Cast Iron	7.50	6.00	0.75	9	260
FGBF04B	4"	125 Cast Iron	9.00	7.50	0.94	15	160
FGBF06B	6"	125 Cast Iron	11.00	9.50	1.00	23	100