

A white, modern, freestanding bathtub is positioned on a balcony. To the left of the tub are two white, ribbed planters containing green grass-like plants. The balcony overlooks a vast city skyline at night, with numerous illuminated buildings and a dark blue sky. The scene is captured from a high angle, looking out from the balcony.

oceania<sup>®</sup>  
water • attitude

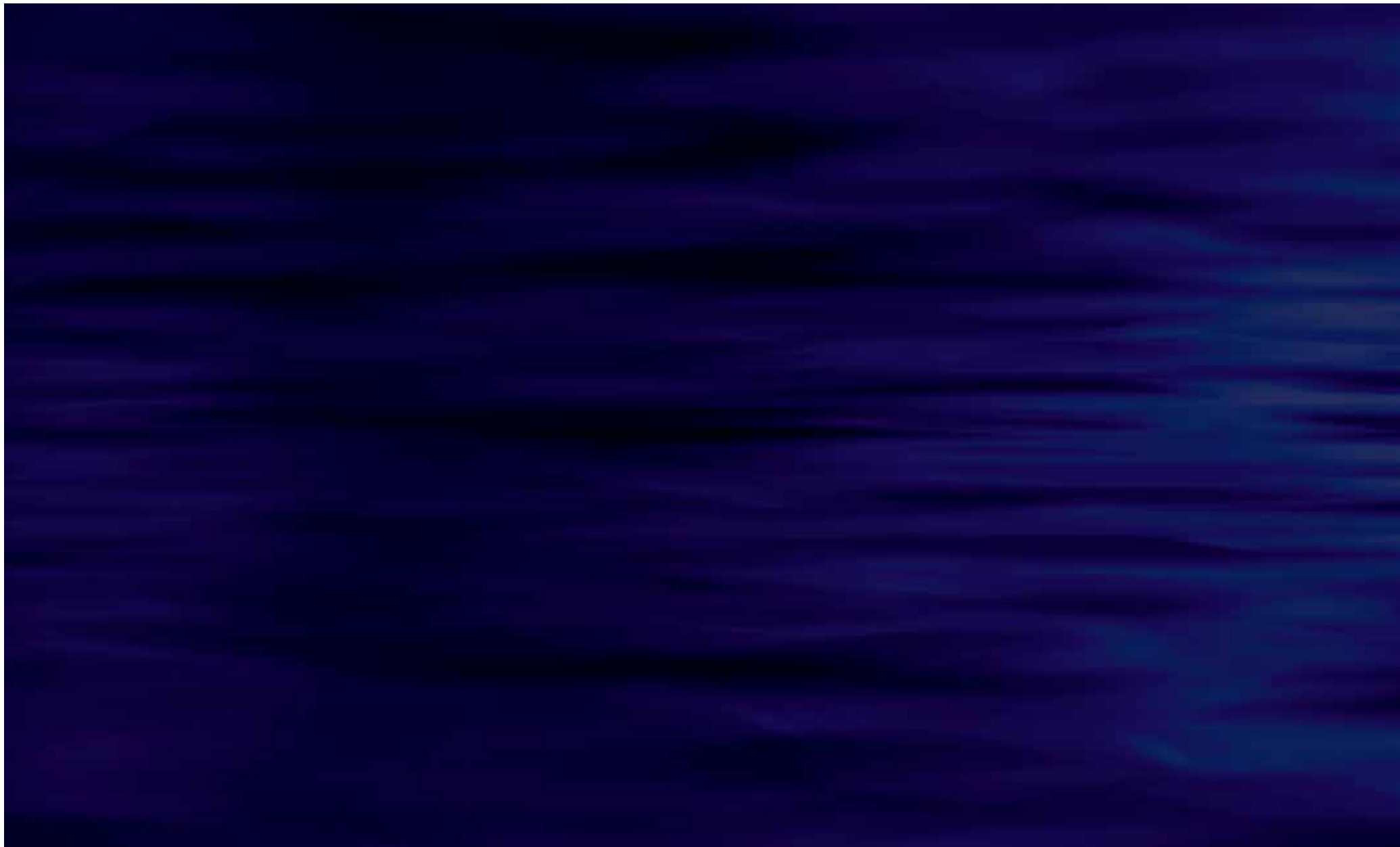

# PERFECTION IN DESIGN • TECHNOLOGY • FUNCTIONALITY

## OCEANIA MEANS CREATIVE INTELLIGENCE

Essential to life, water is the focus of Oceania, which is dedicated to optimizing its presence in the home spa environment.

Oceania innovations set trends. Its premium products stand out for their ingenious and visionary features.

Oceania is a leader in thermoformed acrylic and therapeutic bath systems.

All Oceania products are designed and manufactured in Quebec, Canada, with the greatest respect for the local economy and environment. Perfection in every respect is Oceania's constant concern. What's more, its products are covered by the best guarantee in the industry.

## PERFECTION

Elusive in its astonishing mutability, water embodies the perfection of matter itself





## water • attitude

Because water flows, trickles, rushes and swirls.  
Because water is restorative, soothing and cleansing.

Because water captivates, enthralls and fascinates.  
Because water is the source from which life springs.

We, Oceania, strive to reflect the wealth of its blessings.

Water—our inspiration.

A woman with long, wavy brown hair and blue eyes is looking out from a balcony at a city skyline at night. The city lights are reflected in the water below. A semi-transparent circular graphic is overlaid on the right side of the image.

The comfort  
of an optimized  
design



# OPTIMALE SERIES

Oceania innovates by creating the Optimale Series, a unique juxtaposed bathtub and shower space concept designed to meet the diverse needs of professional contractors. This innovative and original concept creates a feeling of roominess in the smallest spaces.

# ML

## LINEAR MOUNTING (ML)

Placed “in-line” with each other, the assembled bath-shower give an urban and contemporary look to small bathrooms.

This clever and functional integrated bath-shower layout, utilizing only the highest quality and most modern materials, provides unmatched comfort.

Depending on the available space, the shower door is available either sliding or hinged.







## ANGULAR MOUNTING (MA)

The two elements of this bath-shower combination is characterized by the angle of the shower in relation to the bathtub. The angular design gives trendy style and beauty that is perfect for maximizing available space. The shower is available only with sliding door.

# MC

## SIDE MOUNTING (MC)

In this advanced design configuration, the bathtub and the shower are arranged one beside the other. This arrangement is ideal for smaller designed bathrooms. Shower is available with either sliding or hinged doors in the desired size.



## Linear Mounting (ML)

ML1 – Between 2 dividing walls



ML2 – 1 dividing wall on shower

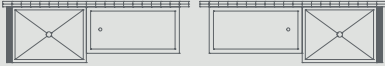

ML3 – 1 dividing wall on bathtub



ML4 – No dividing wall

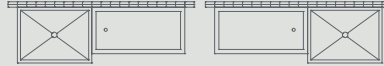

## Angular Mounting (MA)

MA1 – 2 dividing walls, 1 on bath and 1 on shower

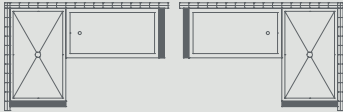

MA2 – 1 dividing wall on bath

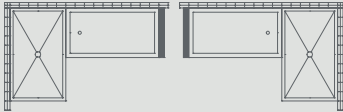

MA3 – 1 dividing wall on shower

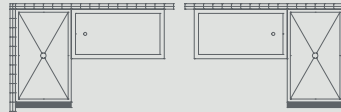

MA4 – No dividing walls

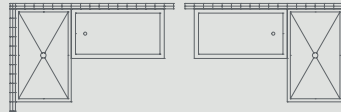

## Side Mounting (MC)

MC1 – 2 dividing walls, 1 on bath and 1 on shower

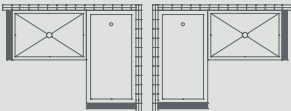

MC2 – 1 dividing wall on bath

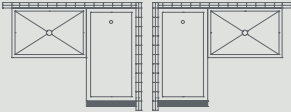

MC3 – 1 dividing wall on shower

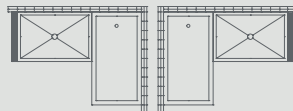

MC4 – No dividing walls

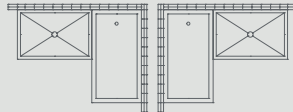

## TYPES OF INSTALLATION

The Optimal Series offers over 70 possible configurations to adapt to available bathtub-shower space.

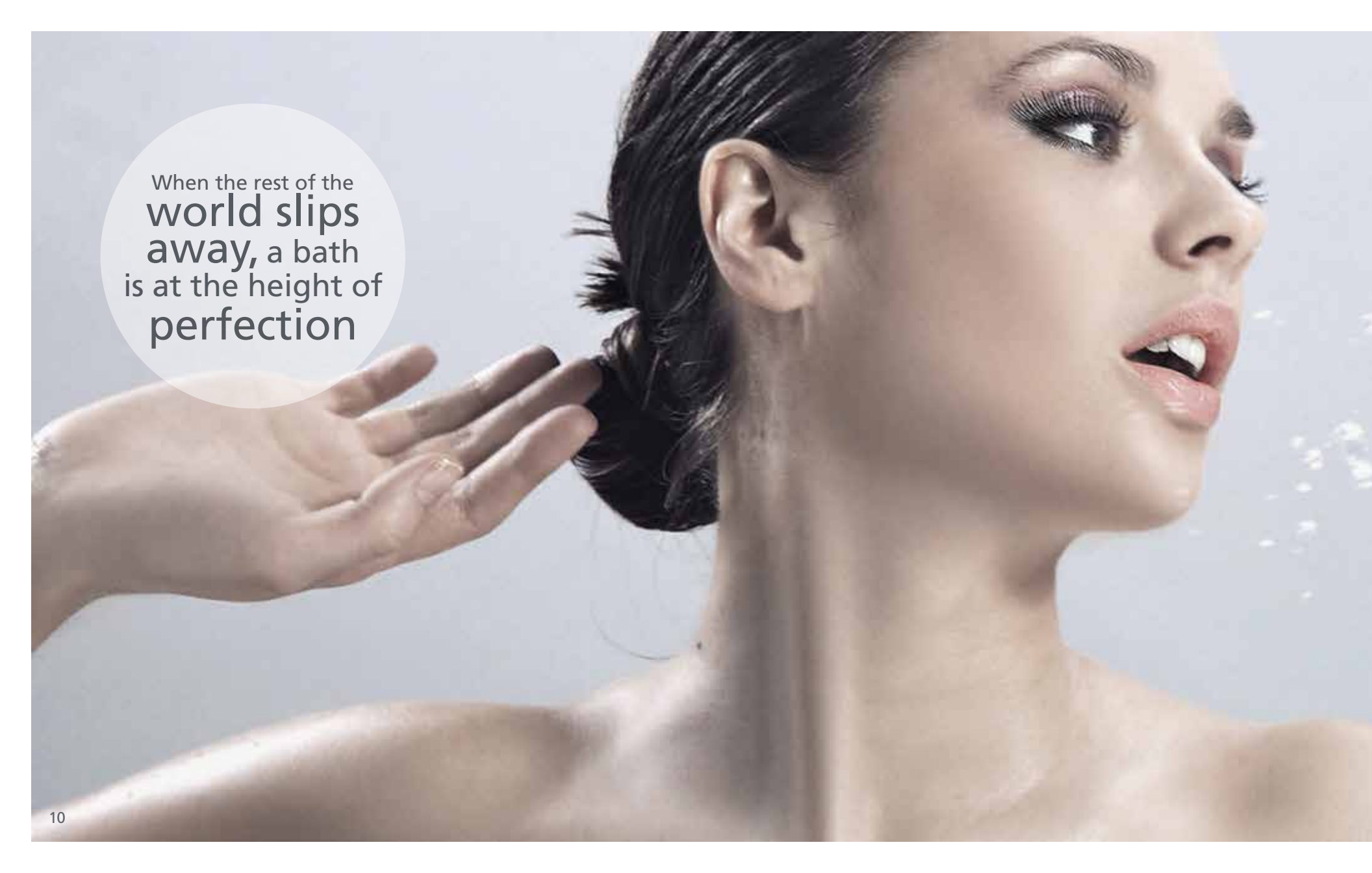
A close-up, profile view of a woman's face and neck, looking upwards and to the right. Her dark hair is pulled back into a bun. A hand is visible on the left side of the frame, with fingers slightly spread, as if gently touching or styling her hair. The background is a soft, light blue-grey color with some water droplets visible on the right side, suggesting a bath or shower setting. The lighting is soft and natural, highlighting the contours of her face and neck.

When the rest of the  
**world slips  
away,** a bath  
is at the height of  
**perfection**



# OCEANIA BATHS

The focus on perfection in design, manufacturing excellence, and the lasting beauty of their surfaces results in Oceania setting the benchmark in terms of superior quality baths.



Irresistibly  
enticing, the jewel  
ensconced  
at the center  
of the space

# FREESTANDING BATHS



Whether single-piece or skirted, with deck- or floor-mounted faucets, Oceania freestanding baths are available in models to fit your every need: floor mounted, pedestal or claw foot.

Most of our freestanding baths are available as soaking or air baths with optional chromatherapy lights.

## EXCEPTIONAL DESIGN

Over the course of many years, Oceania has perfected the design, shapes and looks of its baths to create an extraordinarily broad range of superbly made models to meet today's demands.



**Sublime**  
60" x 32" x 22"  
152 x 76 x 56 cm



**Essential**  
65" x 41 1/2" x 24 1/2"  
165 x 105 x 62 cm



**Soliste 60**  
60" x 36" x 22"  
152 x 91 x 56 cm





**Rose 60 and 65**  
60" x 35" x 21" 152 x 89 x 53 cm  
65" x 35" x 21" 165 x 89 x 53 cm



**Noble**  
72" x 35½" x 23½"  
183 x 90 x 56 cm



**Légende**  
71" x 41½" x 24"  
180 x 105 x 61 cm



**Unity 32**  
60" x 31½" x 21½"  
152 x 80 x 55 cm



**Golfe Xtra 66**  
66" x 36" x 23 1/2"  
168 x 91 x 60 cm



**Grace**  
72" x 42" x 24"  
183 x 107 x 61 cm



**Myriad 66 and 72**  
66" x 36 1/2" x 27 1/2"    168 x 93 x 70 cm  
72" x 36" x 27,5"    183 x 91 x 70 cm



**Sophia**  
 66" x 36" x 23 1/2"  
 168 x 91 x 59 cm



**Juliette 66 and 73**  
 66" x 40" x 37 1/2" 168 x 102 x 95 cm  
 73" x 40" x 36" 185 x 102 x 91 cm  
 73" x 40" x 37 1/2" 185 x 102 x 95 cm



**Delphine**  
 66" x 33" x 31 1/2" 168 x 84 x 80 cm  
 68" x 33" x 27" 173 x 84 x 69 cm



**Suite 2 sides**  
 60" x 31" x 22" 152½ x 79 x 56 cm  
 60" x 32" x 22" 152½ x 81 x 56 cm  
 66" x 32" x 22" 168 x 81 x 56 cm  
 66" x 31" x 22" 168 x 79 x 56 cm



**Suite 3 sides**  
 60" x 31" x 22" 152½ x 79 x 56 cm  
 60" x 32" x 22" 152½ x 81 x 56 cm  
 66" x 32" x 22" 168 x 81 x 56 cm  
 66" x 31" x 22" 168 x 79 x 56 cm



**Freedom**  
 72" x 36" x 23"  
 183 x 91 x 58 cm



**Providence**  
66" x 36" x 22"  
168 x 91 x 56 cm



**Soliste 66**  
66" x 36" x 22"  
168 x 91 x 56 cm



**Union**  
72" x 36" x 20½"  
183 x 91 x 52 cm



**London**  
59" x 31" x 24½"  
150 x 79 x 62 cm



**Kiev**  
65" x 27" x 23"  
166 x 69 x 58 cm



**Lisbon**  
65" x 29" x 24"  
165 x 74 x 61 cm



**Zürich**  
68" x 30" x 23"  
172 x 76 x 58 cm



**Barcelona**  
71" x 31 1/2" x 26"  
180 x 80 x 66 cm

## DESIGNS OF GREAT INFLUENCE

Influence baths by Oceania are creations at the forefront of design with their European-inspired minimalist styling and ultra- contemporary lines. Influence dictates the cutting-edge trends in upscale acrylic baths.



**Napoli**  
70 ½" x 32" x 21"  
179 x 81 x 53 cm



**Vienna**  
62 ½" x 29" x 31"  
159 x 74 x 79 cm





**Florence**  
67" x 29" x 29"  
170 x 74 x 74 cm



**Milano**  
67" x 33 1/2" x 27 1/2"  
170 x 85 x 70 cm



**Milano**  
67" x 33 1/2" x 27 1/2"  
170 x 85 x 70 cm



To blend into the  
**surrounding**  
setting without  
relinquishing its own  
**unique character**

## DECK-MOUNT BATHS



Oceania deck-mounted baths are available in a wide variety of models, many of which can be under-mounted. Many of the rectangular designs can also be optioned with the “low profile” look.

There is an extensive choice of configurations in regard to the positioning of drains and the installation of faucets as well as therapeutic systems.

## MANY OPTIONS

Intelligent design means all our baths can be fitted with additional features, including Oceania air-jet systems, prized for their unsurpassed level of hygiene.



**City 60 and 66**  
60" x 30" x 18½" 152 x 76 x 47 cm  
60" x 32" x 18½" 152 x 81 x 47 cm  
66" x 34" x 20½" 168 x 86 x 52 cm



**Légende**  
71" x 41½" x 24"  
180 x 105 x 61 cm



**Noble**  
72" x 35½" x 22"  
183 x 90 x 56 cm



**Broadway**  
66" x 32" x 23½"  
168 x 81 x 59 cm



**Grace**  
72" x 42" x 24"  
183 x 107 x 61 cm



**Nature**  
72" x 42" x 23"  
183 x 107 x 58 cm



**Sublime 6030 and 6632**  
 60" x 30" x 22" 152 x 76 x 56 cm  
 66" x 32" x 21½" 168 x 81 x 54 cm



**Unity 30 and 32**  
 60" x 30" x 21½" 152 x 76 x 55 cm  
 60" x 32" x 21½" 152 x 81 x 55 cm



**Unity 28**  
 60" x 28" x 21½"  
 152 x 71 x 55 cm

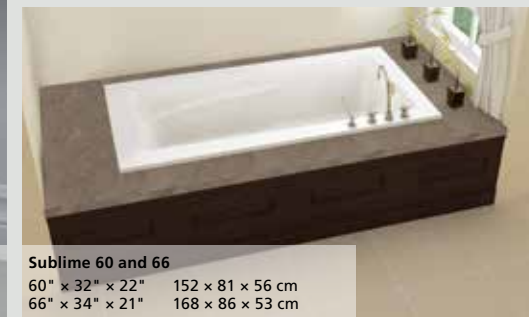

**Sublime 60 and 66**  
 60" x 32" x 22" 152 x 81 x 56 cm  
 66" x 34" x 21" 168 x 86 x 53 cm



**Soliste 60 and 66**  
60" x 36" x 22" 152 x 91 x 56 cm  
66" x 36" x 22" 168 x 91 x 56 cm



**Freedom**  
72" x 36" x 21 1/2"  
183 x 91 x 54 cm

## UNPARALLELED COMFORT

Comfort is one of our top design parameters, involving both the ergonomics of Oceania baths and the functionality of systems and controls.

## EVERY TYPE

Extremely versatile Oceania bath designs allow for a wide choice of configurations—freestanding, skirted, deck mounts, corner or alcove—and singular ease of installation.



**Pure**  
60" x 30" x 18" 152 x 76 x 46 cm  
60" x 32" x 18" 152 x 81 x 46 cm



**Liberty**  
72" x 32" x 21 1/2"  
183 x 81 x 55 cm





**Liberty relax**  
 72" x 32" x 21 1/2"  
 183 x 81 x 55 cm

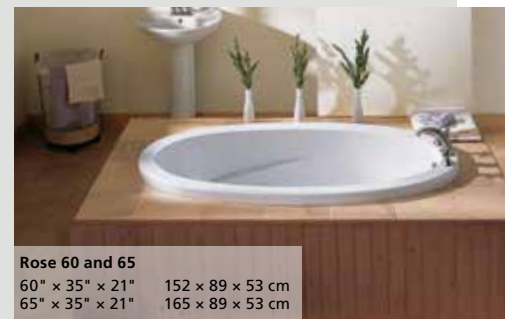

**Rose 60 and 65**  
 60" x 35" x 21"    152 x 89 x 53 cm  
 65" x 35" x 21"    165 x 89 x 53 cm



**Laguna 32 and 34**  
 60" x 32" x 19"    152 x 81 x 48 cm  
 60" x 34" x 20"    152 x 86 x 51 cm



**Essential**  
 65" x 41 1/2" x 24 1/2"  
 165 x 105 x 62 cm



**Sakura**  
60" x 29½" x 16"  
152 x 75 x 41 cm



**Providence**  
66" x 36" x 21½"  
168 x 91 x 55 cm



**Golfe Xtra 66**  
66" x 36" x 23 1/2"  
168 x 91 x 59 cm



**Sophia 66 and 72**  
66" x 36" x 23 1/2" 168 x 91 x 59 cm  
72" x 41 1/2" x 23" 183 x 105 x 58 cm



**Myriad 66 and 72**  
66" x 36 1/2" x 27 1/2" 168 x 93 x 70 cm  
72" x 36" x 27 1/2" 183 x 91 x 70 cm

## EVERY STYLE

There are close to 100 models of Oceania baths to suit every type of interior space and decor: classic, traditional, transitional, modern, New Age, minimalist, trendsetting.

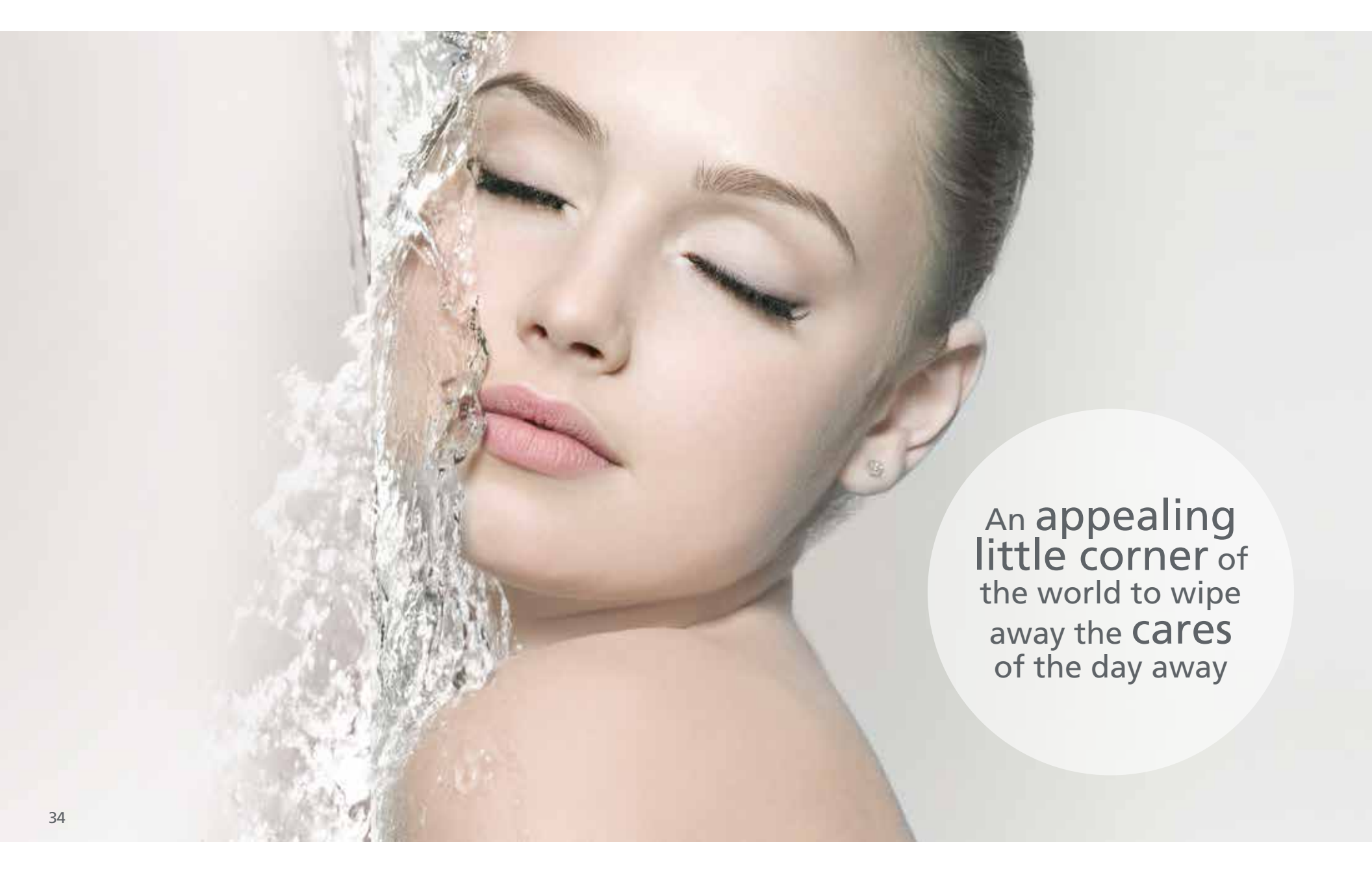

An appealing  
**little corner** of  
the world to wipe  
away the **cares**  
of the day away

## CORNER DECK-MOUNT BATHS



Oceania corner baths stand out for their exceptional comfort and spacious interiors. They are available in both single- and two-person models.

All corner baths are available as soakers or air baths with optional chromatherapy.

## EVERY CONFIGURATION

For incorporation into a spa environment, in the design of Oceania baths the emphasis has been placed on flexibility, whether in terms of mounting arrangements, positioning drains, faucet installation options or bath type (soaking or air bath).



Vallon  
55" x 55" x 20½"  
140 x 140 x 52 cm



**Stéphanie**  
60" x 60" x 22"  
152 x 152 x 56 cm



Health is the  
effervescence  
of the being



A microscopic view of various cells, likely red blood cells, scattered across the frame. The cells are small, circular, and some show a biconcave disc shape. The background is a light, slightly textured grey.

# THERAPEUTIC AIR BATHS

A leader in the development of air baths, for over 20 years Oceania has worked on perfecting technologies and systems that make Oceania therapeutic baths the most advanced, effective and hygienic on the market.





## OCEANIA THERAPEUTIC BATHS

All Oceania baths can be equipped with an air bath therapeutic system and optioned with chromatherapy.

### EVERY STANDARD HAS BEEN SURPASSED...

To skillfully fashion a harmonious union of intensity, warmth and relaxation.

To create an environment in which you are gently swathed with a remarkably effective massage.

### THE EFFECT

- Skin cleansing
- Muscle relaxation
- Stimulation of circulation and the metabolism
- Energizing of the nervous system
- Relaxation of stress and tension



## THE UNIQUE OCEANIA EFFECT

- On the body . . . . . relaxing
- On health . . . . . **stimulating**
- On the mind . . . . . **calming**
- On the self . . . . . **refocusing**
- On the spa environment . . . . . **enhancing**
- On one's own personal universe . . . . . **encompassing**

## TECHNOLOGY—WHERE INTELLIGENT DESIGN MAKES ALL THE DIFFERENCE

- Systems including up to 72 hot-air jets
- Sloped air channels of a design unique to Oceania ensuring 100% drainage and moisture sensors\* guaranteeing a level of hygiene absolutely unmatched in the industry
- Installation on vibration-absorbing adjustable feet for ultra-silent operation
- The most stringent testing in the industry, plus structures and systems on all standard models that are covered by a 20-year limited warranty

\*Except in the case of the Comfort Air™ system, available only in North America

## THERAPEUTIC AIR SYSTEMS

### EXCLUSIVE CONFIGURATIONS

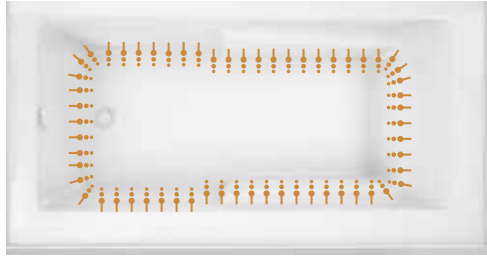

### COMFORT AIR™

Entry-level therapeutic system with up to 60 Easy Clean™ flush hot-air jets and electronic controls. Does not include moisture sensors and uses a standard blower.

(Only available in North America.)



### AEROMASSAGE™

Therapeutic system with 30 to 60 Easy Clean™ flush hot-air jets strategically placed along the lower perimeter of the tub. Includes moisture sensors along with Oceania's exclusive extended-life blower.

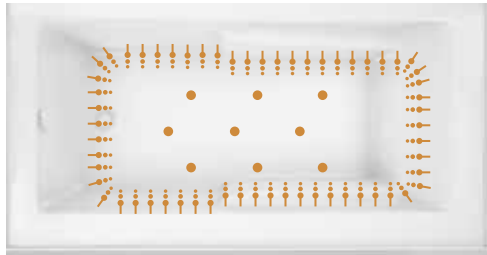

### SUPER AEROMASSAGE™

Includes the AeroMassage system, but with an extra 12 Easy Clean™ flush hot-air jets positioned in the bottom of the tub.

## CHROMATHERAPY



Chromatherapy is based on the principle that colors, which possess various soothing and revitalizing properties, have a beneficial effect on people. Oceania's 20-LED system enables you to utilize various colors to add a new dimension to your therapeutic bath experience.



At times  
a **cascade**,  
at times a  
gentle **mist**;  
behind the glass,  
**water flows**



# OCEANIA SHOWERS

Professional installers laud Oceania showers for a reason. They are the product of the application of intelligent engineering from inception, ensuring their quality in terms of components exceeding standards, unrivaled precision of assembly, and structural integrity guaranteeing uncommon durability.

## ADVANCED DESIGN. TECHNICAL PERFECTION.

For Oceania, today's shower has become an architectural component, a tool for health, a reflection of a lifestyle. That's why we put so much creativity into designing our glass shower enclosures.

### GLASS DOORS

Sliding doors and panels made of 3/8-inch-thick tempered glass. Exclusive Oceania Clear View™ water-repellent treatment.

### MECHANISMS

Oversized glides for effortless sliding motion. Shock-resistant reinforced stops. Bolted hinges.

### STRUCTURE

Extremely rigid structure. Reinforcement bars. 100% Lucite XL™ acrylic one-piece molded bases with composite reinforcements.









California PR2



California PB1



California PB2





Avalanche 36



Poséidon 32/36

## CONTEMPORARY DESIGN - DURABILITY

Oceania one- or two-piece acrylic shower enclosures feature sleek contemporary styling and low-profile sills.

### PREMIUM-QUALITY DOORS

Their quick-release clear or frosted glass sliding doors are mounted on gravity drain slide rails that do not retain any water, ensuring optimum hygiene.

### PRACTICAL CONFIGURATIONS

A number of our acrylic shower enclosures are available in rounded or “Neo-Angled” configurations.

# QI-100 & QI-105 BATH SCREENS

## INGENUITY – FUNCTION

The ideal solution for bath and shower combos, allowing anytime faucet access, the innovative design of the QI-100 and QI-105 screens offers a host of advantages.



## OCEANIA SHOWER KITS

Oceania shower door and base combinations enable you to quickly create an elegant shower in a tiled corner, even when space is at a premium. They feature quick-release sliding doors, and are available in rounded or “Neo-Angled” configurations.

## SHOWER BASES

Rectangular acrylic base,  
left-hand drain



Rectangular stainless steel base,  
center drain



36" x 36" x 2 1/2" rounded corner  
textured base



38" x 38" x 2 1/2" Neo-Angled  
corner textured base



## LUCITE XL™ ACRYLIC SHOWER BASES

Made of 100% Lucite XL™ acrylic, Oceania shower bases are the product of the same technology used to manufacture our baths, resulting in the same quality surface, rigidity and durability features.

## STAINLESS STEEL SHOWER BASES

Their trendsetting metal construction and sleek design make Oceania's exclusive stainless steel shower bases the preferred choice for today's fashionable bathroom. They offer premium showering comfort—much more than ceramic tile—and low-maintenance ease.



## A SOLID WARRANTY

All Oceania products, with the exception of glass shower doors, are designed, manufactured and assembled in the Canadian province of Quebec. That choice results in a very tangible benefit for both you and us: our people work together diligently from design to delivery, with nothing escaping their intense focus on quality control.

The structure and system of the products in our regular lines are covered by a 20-year limited warranty. The Dignité model in the Estime series and Comfort Air™ models are covered by a 5-year limited warranty. The shower doors are covered by a 10-year limited warranty. The bathtub of the Influence series are covered by a 10-year limited warranty.

You can find a complete and exact description of the terms of that warranty on our website:

[oceania-attitude.com](http://oceania-attitude.com)



## THE ENVIRONMENT – A RESPONSIBLE ATTITUDE THAT'S EXEMPLARY

Here at Oceania, environmental responsibility is much more than a simple corporate value. For us, it's an urgent necessity.

We have set up very strict policies designed to minimize the environmental impact of our operations and boost the sustainability of resources. Our priority: to ensure we always make the smartest, most responsible choices in respect to the environment.

We are especially proud of our accomplishments and we will not cease to intensify our efforts.





May water live  
May it flow,  
soothe,  
and delight



oceania<sup>®</sup>  
water • attitude

591 Avenue des Entreprises  
Thetford Mines, Quebec  
Canada G6H 4B2

**Head Office, Order Desk &  
Technical Support**

T 1 877 332-4224

F 1 866 460-4334

[www.oceania-attitude.com](http://www.oceania-attitude.com)